

DAVIT BASE - POST-INSTALL

This detail is a method to install the bases after the main slab is poured but still classed as a 'cast-in'. Starter bars need to be included in the main slab pour then the plinth can be added/poured separately over the starter bars

DAVIT BASE - SLAB THICKNESS INSUFFICIENT

This detail is can be used if the main slab thickness is not deep enough. Starter bars need to be chemically fixed into the existing slab. The 4 main all-threads need to be fixed into the main slab by min 75mm and then the plinth poured around it all. All-threads can also be installed after but min 75mm embedment is important.

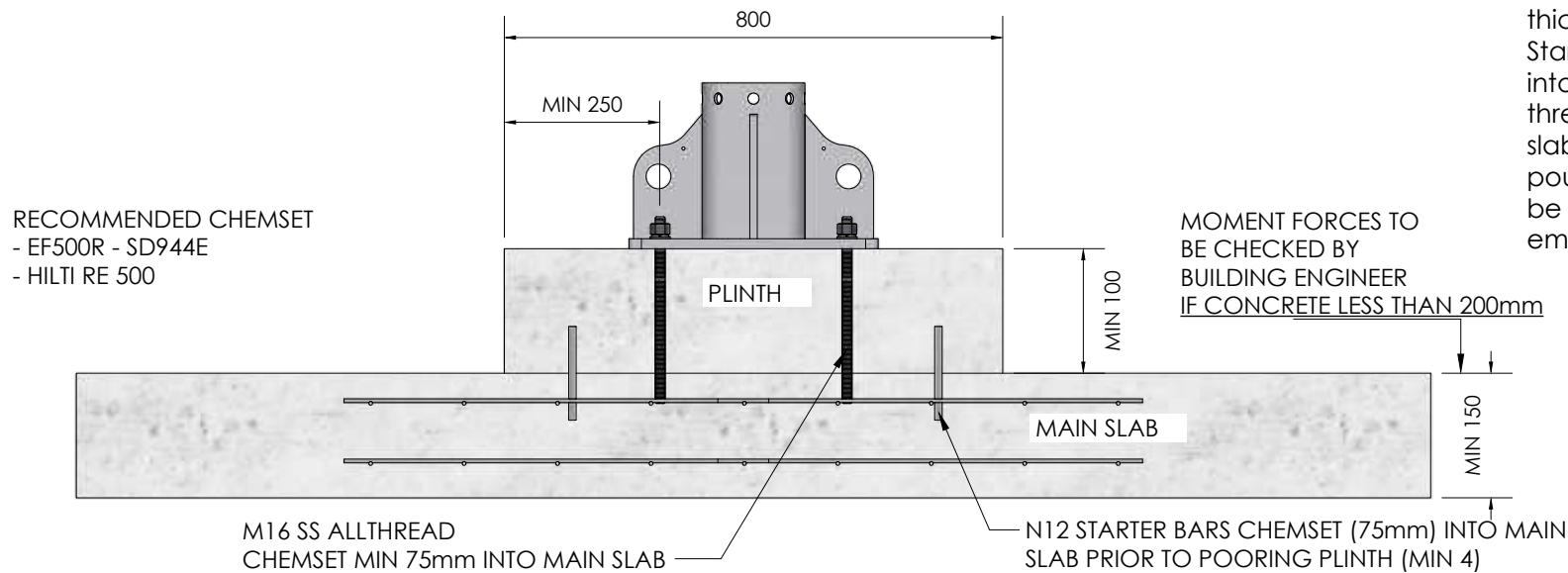

RECOMMENDED CHEMSET
- EF500R - SD944E
- HILTI RE 500

Kattsafe

A 1029 MOUNTAIN HWY BORONIA VIC 3155
T +61 1300 301 755
E sales@kattsafe.com.au
W kattsafe.com.au

Description

Davit base on concrete plinth
options

Code

OH400

| Rev | Date | BY | CHK | COMMENTS | DRG No. | D9269 |
|-----|------------|----|-----|------------------------|---------|-------|
| 3 | 23/04/2024 | MV | KB | Added concrete details | | |

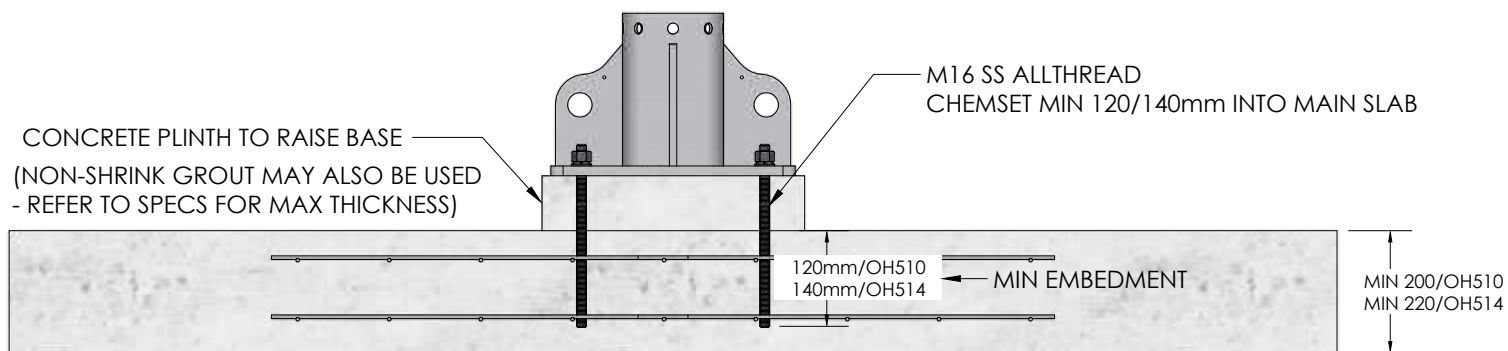

DAVIT BASE - RAISED PLINTH/WATERPROOFING

This detail is used when water proofing or a raised plinth is required. The all-thread must be embedded a min of 120/140mm into the main slab. The all thread can be fixed into the main slab then the plinth added after. Using a template to ensure the threads align with the base holes is very important.